

SANDY SOIL BEARING CAPACITY 200 - 400kPa									
PIPE	11 1/4" BEND	22 1/2" BEND	45° BEND						
DIAM.	X mm	D mm	Z mm	X mm	D mm	Z mm	X mm	D mm	Z mm
75	200	100	100	200	175	150	450	150	175
100	200	150	100	450	325	350	550	550	325
150	250	200	200	550	425	400	700	750	475
200	350	250	250	700	475	450	850	850	575
250	400	350	300	800	575	500	1000	900	625

BENDS (11.25°, 22.5° AND 45°)

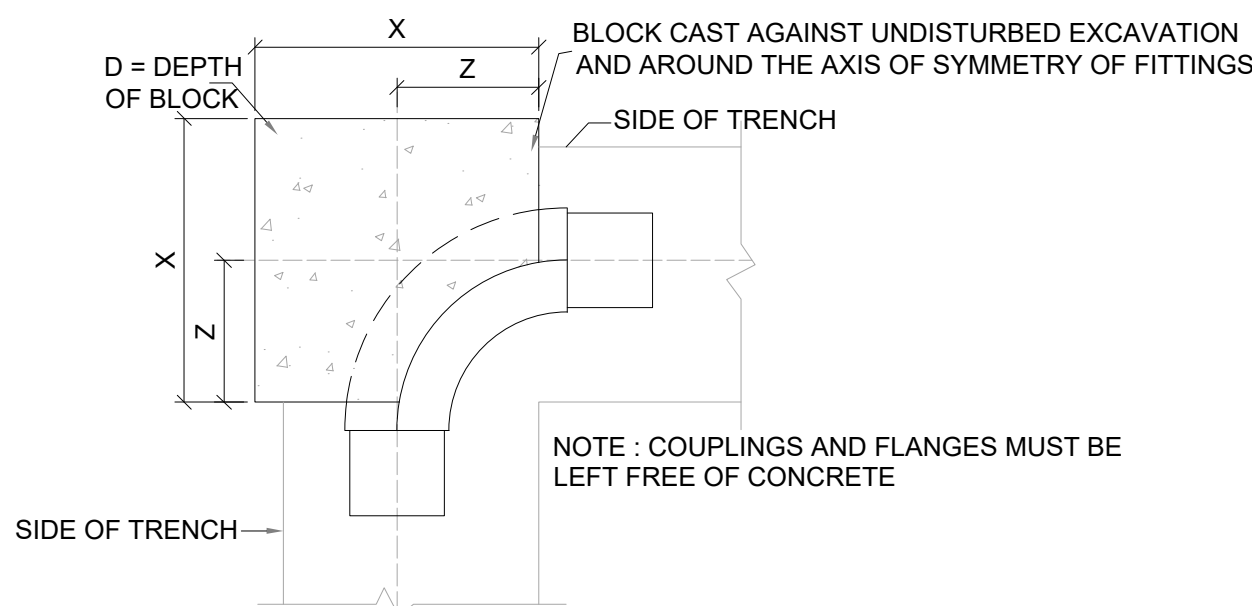

SANDY SOIL BEARING CAPACITY 200 - 400kPa			
PIPE	90° BEND		
DIAM.	X mm	D mm	Z mm
75	380	440	360
100	500	500	500
150	750	900	800
200	1000	1100	960
250	1500	1275	1030

BEND (90°)

- NOTES:
1. ALL CONCRETE TO BE GRADE 25/19mm.
 2. TABLE WAS CALCULATED FOR THRUST BLOCK IN SANDY SOILS.
 3. ENCASEMENT TO BE CONSTRUCTED IN ACCORDANCE WITH SANS 1200 LB, CLAUSE 5.4.
 4. DIMENSION COULD BE INCREASED TO (O.D + 300mm) WHERE THE SOIL CONDITIONS AND PIPE CLASS & SIZE WARRANT IT.

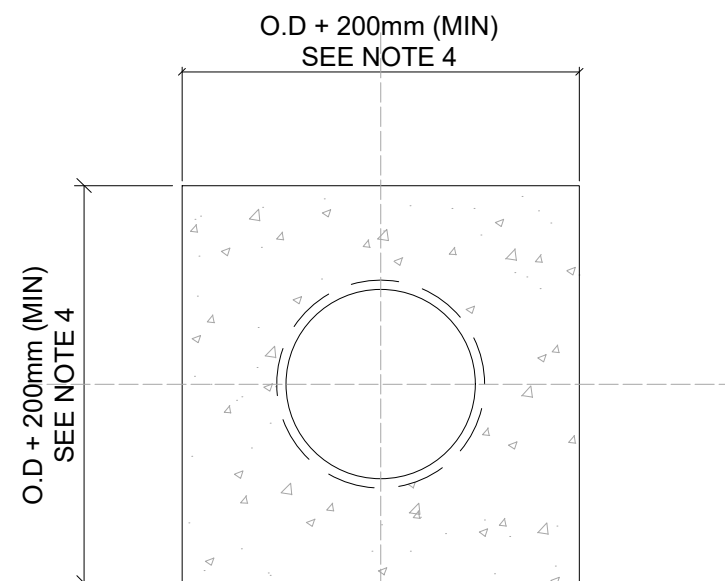

CONCRETE ENCASEMENT TYPICAL DETAILS (FLEXIBLE PIPE)

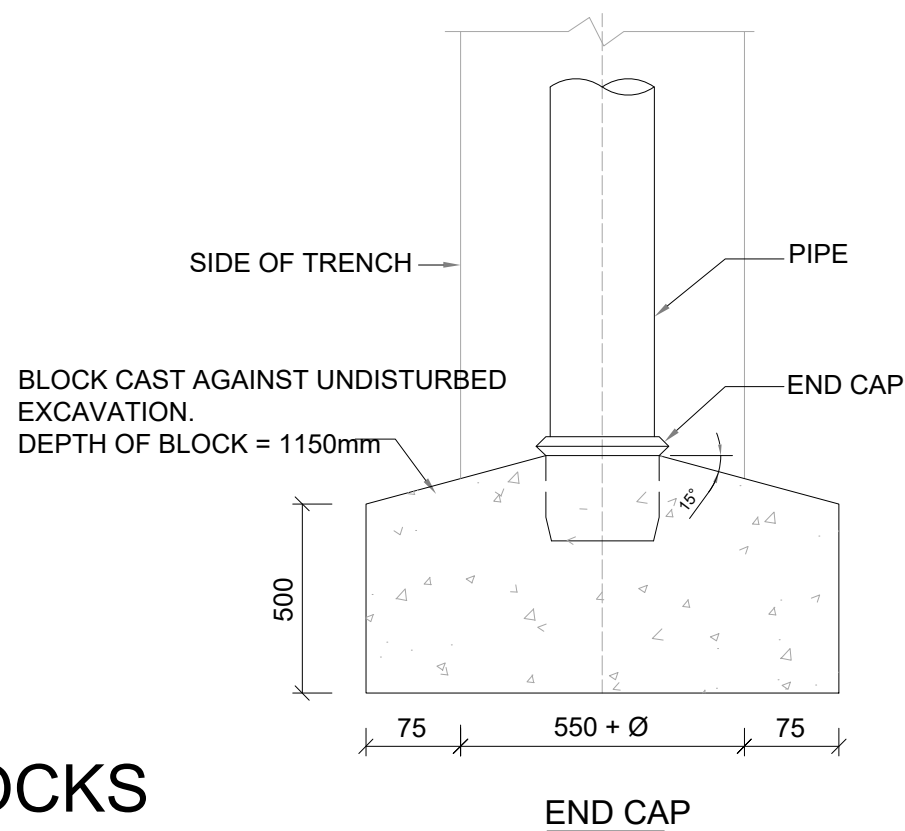
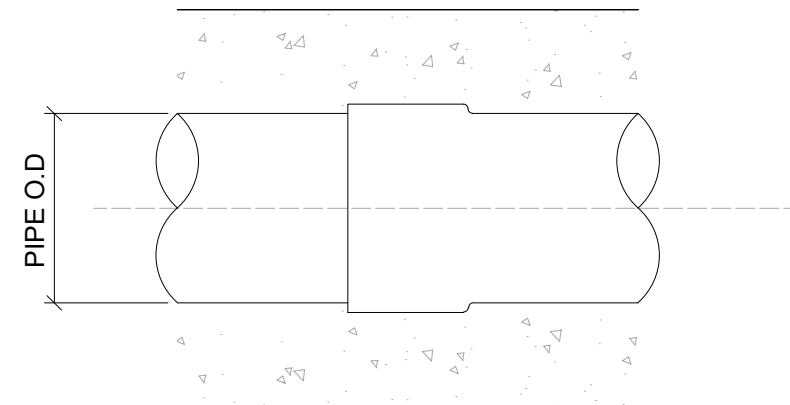

THRUST/ANCHOR BLOCKS TYPICAL DETAILS NTS

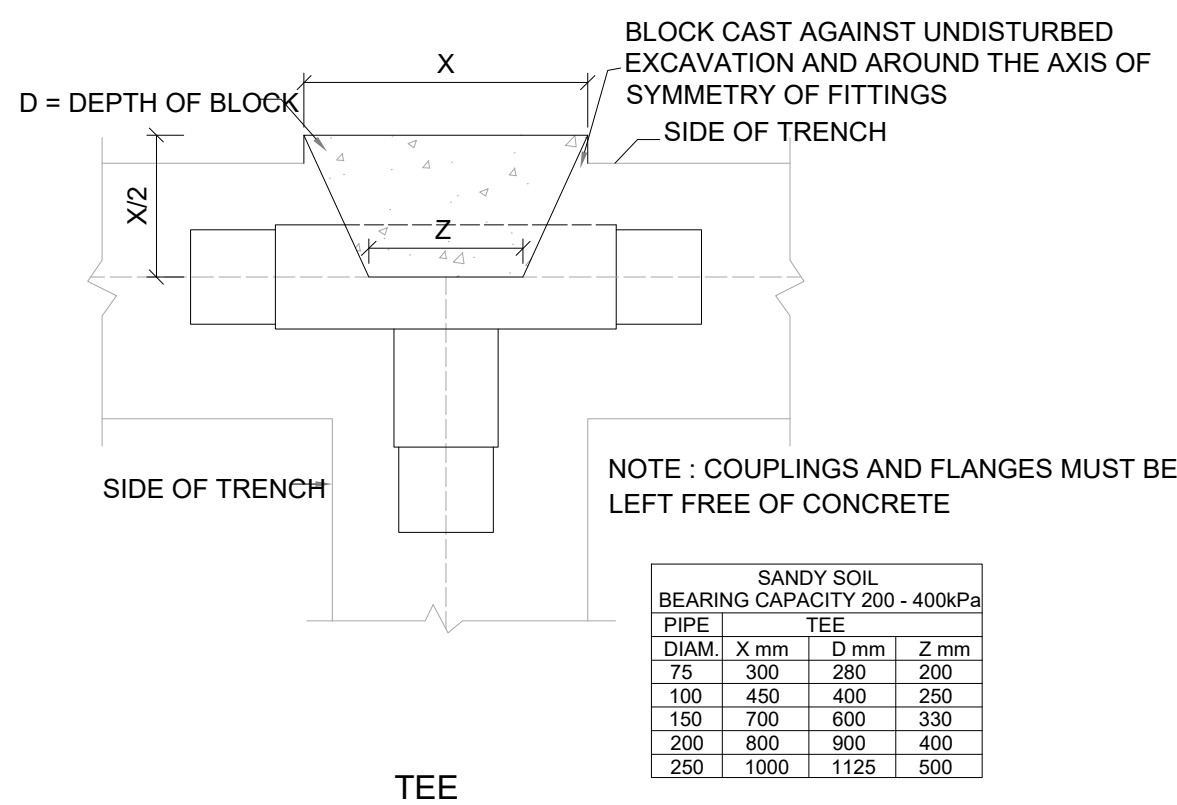

SANDY SOIL BEARING CAPACITY 200 - 400kPa			
PIPE	TEE		
DIAM.	X mm	D mm	Z mm
75	300	280	200
100	450	400	250
150	700	650	330
200	800	900	400
250	1000	1125	500

TEE

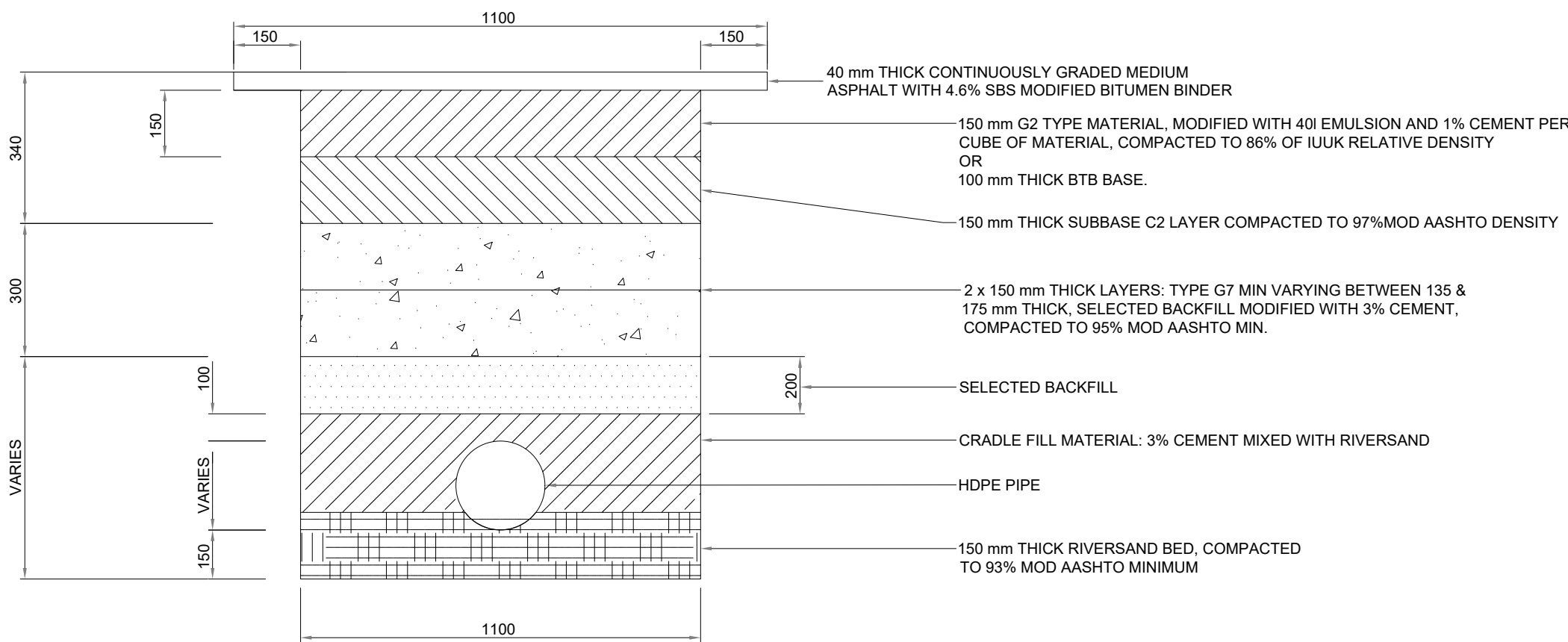

TYPICAL TRENCH BACKFILL FOR Ø32 - Ø75 HDPE PIPES

SCALE: N.T.S.

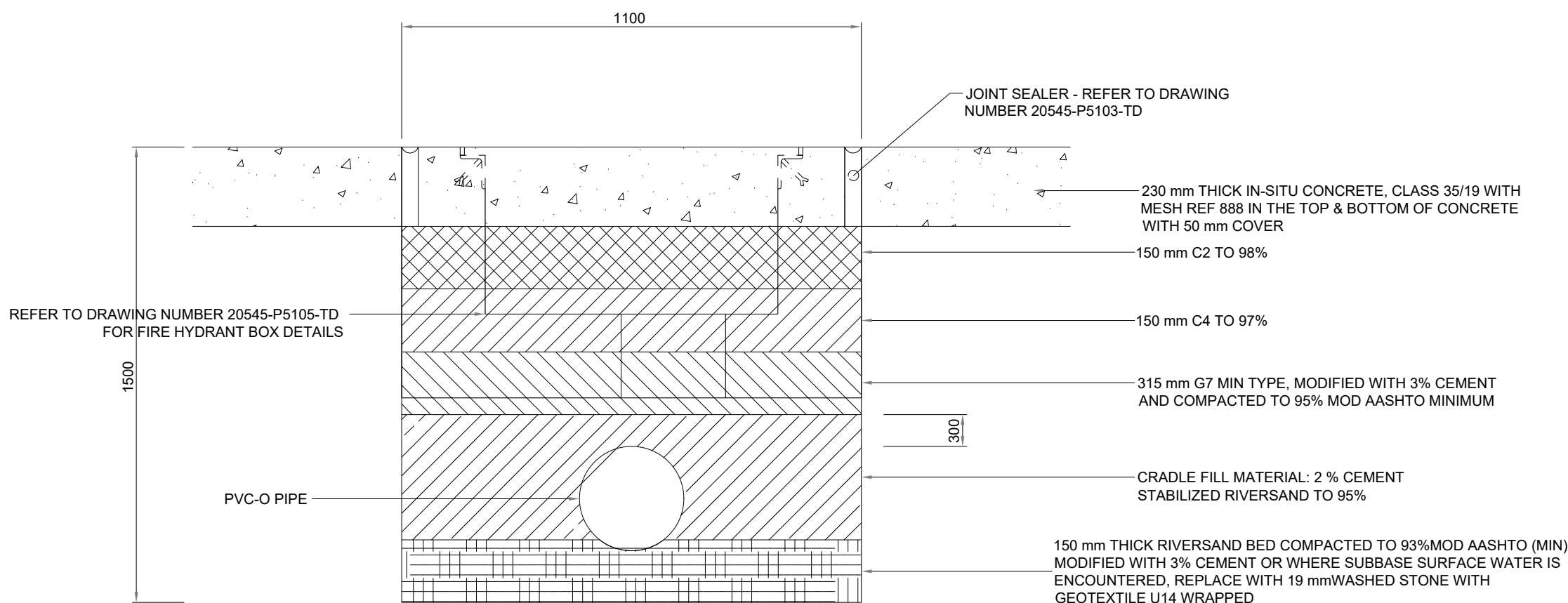

TYPICAL BACKFILL FOR CONCRETE SURFACED AREAS

SCALE: N.T.S.

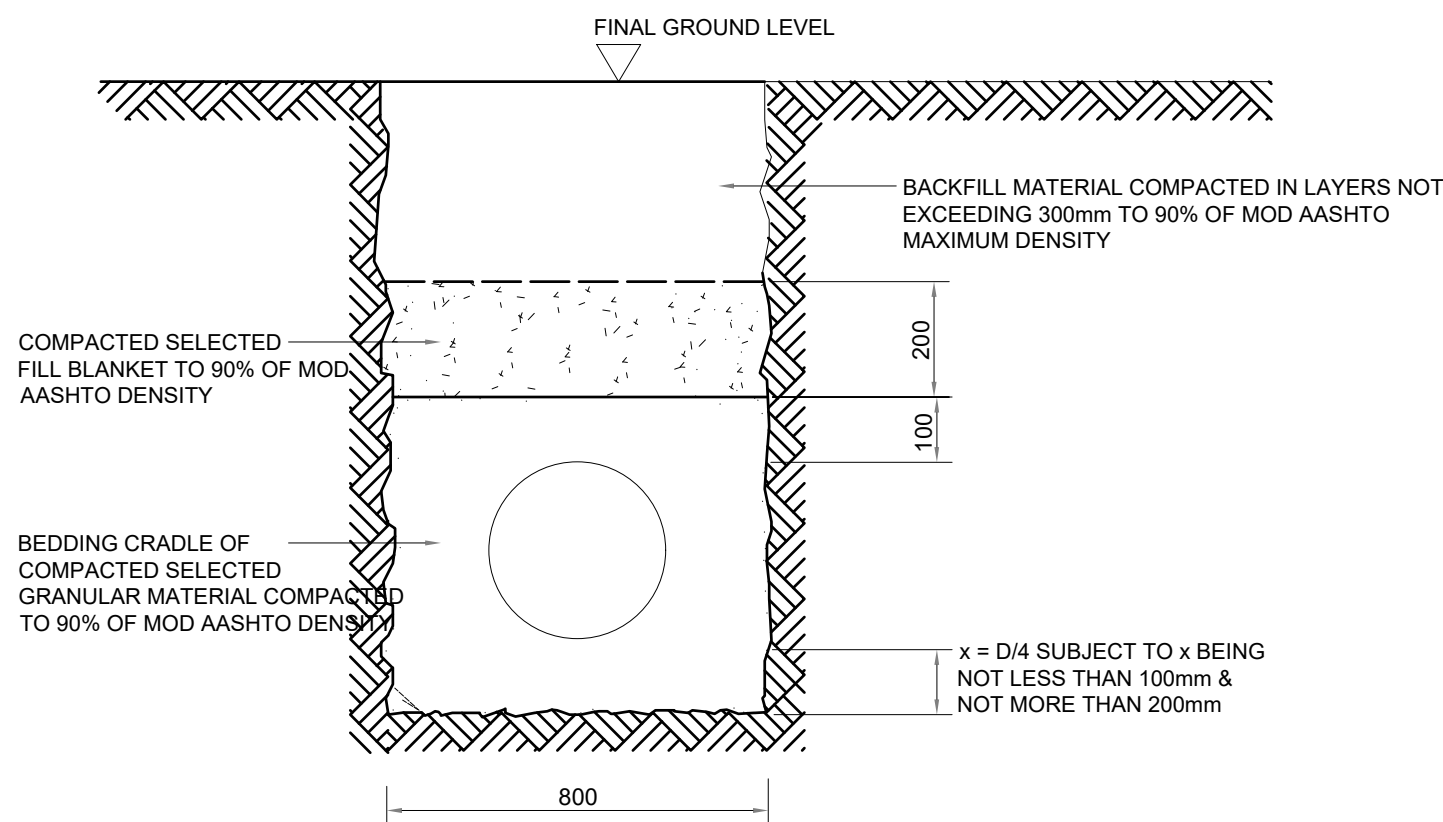

PIPE BEDDING DETAILS: FLEXIBLE PIPES

TYPICAL SECTION
SCALE: N.T.S

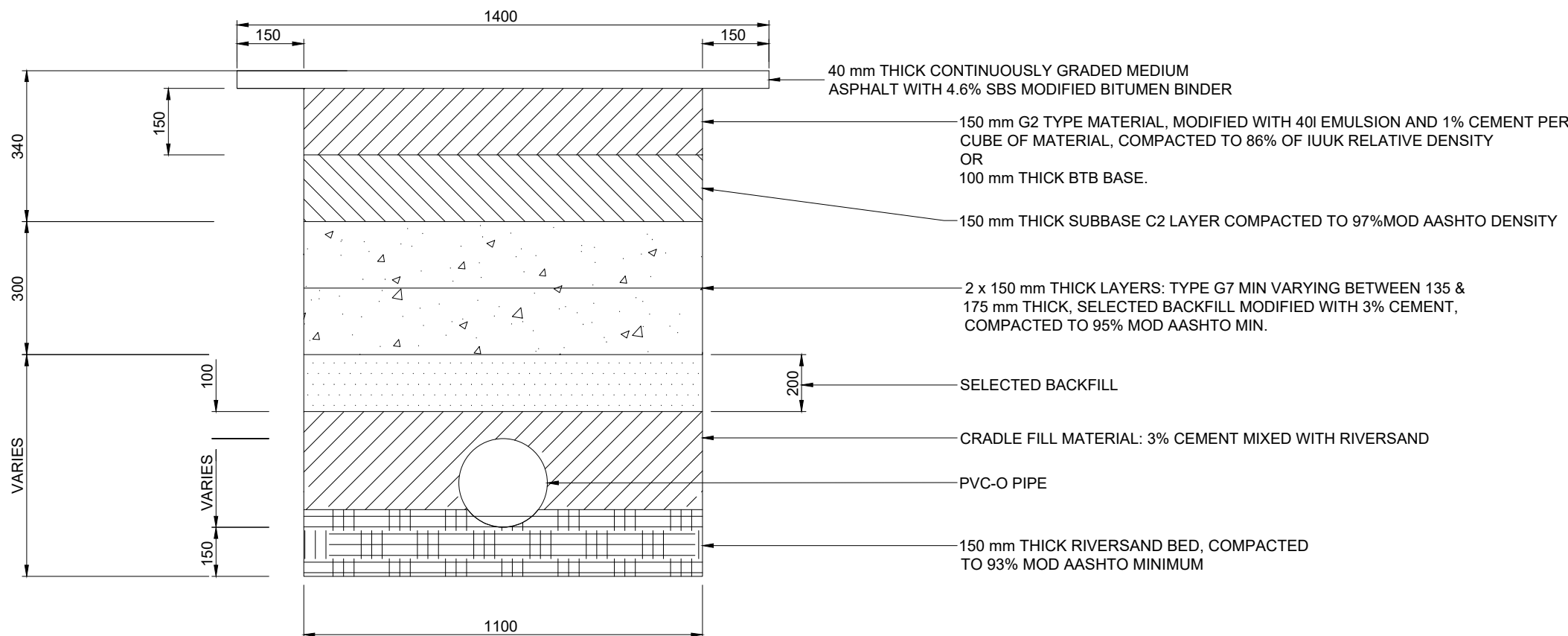

TYPICAL TRENCH BACKFILL FOR Ø110 - Ø400 PVC PIPES

SCALE: N.T.S.

FOR APPROVAL



PROJECT / AREA / ASSET / SUBJECT

PORT OF DURBAN DRAWING STANDARDS

DRAWING TITLE
**INSTALLATION OF AUTOMATIC METER
READERS TO ISOLATE TPT FROM TNPA
WATER RETICULATION**
Typical thrust block & bedding details

DATE	2021-10-26	DR - DESIGN CENTRE MANAGER MR. R. M. VILERO
SCALE	AS SHOWN	SIGNATURE DATE
DESIGNED BY	RB	DR - PORT ENGINEER MR. M. Setake
CHECKED BY		SIGNATURE DATE
DRAWN BY	RB	DR - PLAN DRAWER MR. R. Bernade
CHECKED BY	RV	SIGNATURE DATE

PAPER SIZE	TRANSNET DRW. NO.	SHEET	REV.
A1	DH61-J-904-015-00		
CONSULTANT / CONTRACTOR DRW. NO.			