

## Regional Office Samastipur

1<sup>st</sup> floor, Panchawati Complex, Mohanpur Road, Samastipur - 848101  
 Telephone: 06274-225414, email -pssrosamastipur@unionbankofindia.com

**Subject: Uploading of BOQ & Tender Document for Furnishing work of Premises of Kishunpur Baikunth (Warisnagar) Branch on Bank's and Govt. website**

Eligibility	<b><u>Only Empanelled vendors of Regional Office, Samastipur can apply.</u></b>
Earnest Money Deposit	Rs. 16,000/- for Premises Furnishing work of Kishunpur Baikunth (Warisnagar) Branch by Demand Draft payable at Samastipur and drawn in favor of Union Bank of India.
Document cost	Rs 500.00
Period of Work Completion	21 days
Duration of Tender	21 days
Date of Issue of Tender	From 06.04.2022 to 26.04.2022 during office hours
Last date of submission of tender	Up to 02:00 PM on 26.04.2022.
Date & Time of opening of Tender	04:00 PM on 26.04.2022.
Details of Architect	M/s Artcon Design Cosultants, G-04, Laxmi Palace, Mitra Compound, Boring Road, Patna 800001

**Submit Application/ Bid for Furnishing work in sealed envelope with complete tender document.**

**Dy. Regional Head**



## Regional Office Samastipur

1<sup>st</sup> floor, Panchawati Complex, Mohanpur Road, Samastipur - 848101  
Telephone: 06274-225414, email - [pssrosamastipur@unionbankofindia.com](mailto:pssrosamastipur@unionbankofindia.com)

## Invitation to Tenderer

Instruction to Tenderers

and

General Conditions of Contract

for

## **Interior Furnishing Work**

at premises of

Union Bank of India, Kishunpur Baikunth (Warisnagar) Branch

## Index

-----

1. Section - 1 (Tender Notice)
2. Section - 2 (Letter Submitting Tender)
3. Section - 3 (Specimen Copy of Agreement)
4. Section - 4 (General Conditions of Contract)
5. Appendix Referred to in the General Conditions
6. Technical Specification for Furnishing Works
7. Approved Material Specification for Furnishing Work
8. Bill of Quantities for Furnishing Work
9. Furnishing Work Layout

\*\*\*\*\*

## Tender Notice

To,

-----

-----

-----

(Name & Address of the Contractor)

Dear Sir (s)

**Subject- Furnishing Work of Premises of Union Bank of India, Kishunpur Baikunth  
(Warisnagar) Branch**

You are requested to submit your tender for the above mentioned work for which schedule of quantities, general conditions, special conditions/ additional conditions can be had from the office of The Regional Head, Union Bank of India, Regional Office Samastipur, 1st Floor, Panchawati Complex, Mohanpur Road, Samastipur (Bihar) during working hours.

Sealed tenders accompanied by bank Demand Draft for Rs.16,000/- as Earnest Money in favour of Union Bank of India payable at Samastipur should reach this office on or before 2:00 PM on dated 26.04.2022 in sealed cover. The tenders shall be opened on 26.04.2022 at 04:00 PM. The tenders received late on account of any reason whatsoever shall not be entertained.

The tender shall be valid for a period of not less than 60 days of opening of tender.

Time of Completion: 21 days (From date of award of work)

The Union Bank of India, Regional Office Samastipur shall not be bound to accept the lowest tender & reserves the right to accept or reject any or all the tenders without assigning any reason whatsoever.

Yours' faithfully,

(Seal & Signature for Union Bank of India, Regional Office Samastipur (Bihar))

## Letter Submitting Tender

To,

-----

-----

-----

Dear Sir.

With reference to the tender invited by you for the Furnishing work of premises of Union Bank of India, Kishunpur Baikunth (Warisnagar) Branch, (Bihar) under Samastipur region.

I/ We do hereby offer to execute the work under contract at the respective rates mentioned in the Schedule of quantities. I/We have seen the site, understood the general conditions of contract, schedule of quantities etc.

I /We agree to execute the work as per specification, general conditions of contract, special conditions, additional conditions, schedule of quantities etc.

I /We have deposited earnest money Rs.16000/- by demand draft which amount is not to bear any interest. I/We do hereby agree that this sum shall be forfeited by you in the event our tender is accepted and I/We fail to execute the contract when called upon to do so.

I /We understanding that you are not bound to accept the lowest or any tender that you receive

Yours faithfully,

(Seal & Signature of Contractor)

1) Name of Partner (s) of the firm.

2) Name of banker

3) Demand Draft No. \_\_\_\_\_ Dated \_\_\_\_\_ Tender submitted on  
\_\_\_\_\_ before \_\_\_\_\_ P.M.

Specimen copy of Agreement

(Subject to change in order to availability from Central Office)

**For works exceeding Rs.10.00 Lac agreement should be drawn on stamp paper.**

Articles of Agreement:

Agreement made at \_\_\_\_\_ this \_\_\_\_\_ day of \_\_\_\_\_ between Union Bank of India, Regional Office, Samastipur, 1<sup>st</sup> Floor, Panchawati Complex, Mohanpur Road, Samastipur (Bihar) herein referred to as the successful tender/contractor which expression shall include his heirs, executors, administrators and assigns of the order part. Whereas Union Bank of India, Regional Office Samastipur, 1<sup>ST</sup> Floor, Panchawati Complex, Mohanpur Road, Samastipur (Bihar) is desirous of carrying out of the **Furnishing work of premises of Union Bank of India, Kishunpur Baikunth (Warisnagar) Branch, (Bihar)** and has caused specification etc. describing the work to be done as per schedule of quantities along with the general conditions of contract, special condition additional conditions etc. and whereas the contractor has agreed to execute the work described in said priced schedule of quantities, general conditions of contract, special condition, additional condition at the respective rates mentioned in the priced schedule of quantities attached.

Whereas the contractor has deposited Rs.16000/- with the Union Bank of India, Regional Office 1<sup>st</sup> Floor, Panchawati Complex, Mohanpur Road, Samastipur (Bihar) as earnest money for due performance of the agreement.

Now it is hereby agreed as follows:

1. In consideration of the payment to be made to the contractor as herein provided he shall upon and subject to the said conditions execute and complete the work as per the said conditions and priced schedule of quantities.
2. The Union Bank of India, Regional Office Samastipur, 1<sup>st</sup> Floor, Panchawati Complex, Mohanpur Road, Samastipur (Bihar) shall pay the contractor such sums as shall become payable hereunder at the times and in manner specified in the conditions.
3. The said conditions shall be read and form part of the agreement and the parties hereto shall respectively abide by and submit themselves to the conditions and stipulations and perform the agreement on their parts respectively on such conditions contained.
4. All disputes arising out of in any way connected with this agreement and the parties hereto shall respectively abide by and submit themselves to the conditions and stipulations and perform the agreement shall be deemed to have arisen in \_\_\_\_\_ and only the Court / Arbitrator in \_\_\_\_\_ Shall have jurisdiction determine the same.
5. The several parts of this contract have read to us and fully understood by us.

(Witness)

Union Bank of India, Regional Office Samastipur

(Contractor)

## **General Conditions**

1. Sealed tenders should be addressed to The Regional Head, Union Bank of India, Regional Office Samastipur, 1<sup>st</sup> Floor, Panchawati Complex, Mohanpur Road, Samastipur (Bihar) and superscribed **Name of Work - Furnishing Works at Premises of Union Bank of India, Kishunpur Baikunth (Warisnagar) Branch**, and should reach the office before 2:00 PM on 26.04.2022.
2. **Duration of Tender from 06.04.2022 to 26.04.2022 and last date for submission of tender on 26.04.2022 till 2:00 PM. No tenders shall be received after 2:00 P.M on 26.04.2022 and the tenders shall be opened on 26.04.2022 at 04:00 P.M. unless otherwise informed.**
3. Any clarification (in writing) whatsoever shall be sought from the Architect, minimum two days before the tender submission date.
4. The tender shall remain valid for a period of 2 months from the date of opening of tenders Union Bank of India, Regional Office Samastipur, 1<sup>st</sup> Floor, Panchawati Complex, Mohanpur Road, Samastipur (Bihar) and reserves the right to accept or reject any or all the tenders without assigning any reason to do so.
5. At the time of submission, every tender must be accompanied by a Demand Draft of Rs.16000/- in favour of Union Bank of India, Regional Office Samastipur and as Earnest Money Deposit and No interest shall be paid on earnest money. Any tender which is not accompanied by the earnest money shall be summarily rejected. Firms registered with National Small Industries Corporation (NSIC) submitting valid proof documents would be exempted from payment of Earnest Money Deposit.
6. The tender should quote the rates in figures as well as in words.
7. All erasures and alterations made while filling the tender must be attested by initials of Tenderer. Overwriting of the figures is not permitted.
8. The earnest money deposit of unsuccessful tenders shall be returned after the tender is decided or on expiry of validity period.
9. The earnest money of the successful tender shall be adjusted in the initial security deposit.
10. The Union Bank of India, Regional Office Samastipur, 1<sup>st</sup> Floor, Panchawati Complex, Mohanpur Road, Samastipur (Bihar) and reserved right to reject any or all the tenders accept part of any tender or entrust the entire work to any contractor or divide the work to more than one contractor (item wise) without assigning any reason or giving any explanation . The rates quoted by the contractor shall hold good for this bifurcation and no compensation shall be paid on this account.
11. Joint tenders shall not be considered.

12. On receipt of intimation from the Union Bank of India, Regional Office Samastipur, 1<sup>st</sup> Floor, Panchawati Complex, Mohanpur Road, Samastipur (Bihar) and of the acceptance of his tender the Tenderer within 3-days should submit his acceptance of the work order. If the successful Tenderer fails to undertake the work, the earnest money deposited by him shall be forfeited and acceptance of his tender may be withdrawn.
13. The rates quoted in the tender shall include all charges of shifting of furniture, scaffolding, ladder, lift up and down mechanical transportation, loading, unloading, any or special tools and plants railway freight, labor taxes etc. It shall also take care other taxes of expenditure for carrying out the work. The rate quoted in the tender shall also include for the charges for carrying out various types of laboratory / site tests for different types of materials.
14. The Contractor shall arrange water and electricity for completing the work.
15. No escalation in rates shall be allowed under any circumstances.
16. The Successful Tenderer is bound to carry out entire work within the period stipulated in the Appendix. The Tenderer shall have to pay liquidated damages for non completion of job within stipulated period at the rate of Rs.1,000/- per day for the first week and Rs.2000/- per day after that, with a maximum limit of 5% of the total contract value.
17. The Liquidated damages as mentioned above may not be enforced if the contractor applies for extension of time mentioned the reasons for extension. Extension of time in days shall be granted by the Union Bank of India, Regional Office Samastipur, 1<sup>st</sup> Floor, Panchawati Complex, Mohanpur Road, Samastipur (Bihar) and if it is proved that contractor is not at fault for extending the work beyond stipulated date of completion.
18. The Successful Tenderer is bound to carry out items of work necessary for completion of job even though the same are not included in the schedule of quantity. Rates of extra items shall be derived from the tender. In case the rates do not exist in the tender and extra item is not similar to tender item. Then the rates shall be worked out on the prevailing market cost of material and labour including wastage plus 15% towards tax and Contractor's profit.
19. The Contractor must co-operate with other contractor appointed by the Union Bank of India, Regional office 1<sup>st</sup> Floor, Panchawati Complex, Mohanpur Road, Samastipur (Bihar) and so that entire work shall proceed smoothly with least possible delay and to the satisfaction of the Union Bank of India, Regional Office Samastipur, 1<sup>st</sup> Floor, Panchawati Complex, Mohanpur Road, Samastipur (Bihar)
20. The Contractor shall remove all malba etc. wash and clean the floors regularly at his own cost and hand over the site in proper manner on the completion of work.
21. The Tenderer is advised to visit the site and acquaint himself with the site conditions making his own arrangement for storing of material at site lift, cartridge, etc.



22. The Initial Security Deposit shall be made, @ 2% of the accepted contract value less (subtracting) earnest money deposit, by the successful Tenderer within 07 days of acceptance of his tender. It shall be submitted in form of Bank Draft in favor of Union Bank Of India payable at Samastipur
23. The Successful Tenderer shall have to enter in to an agreement with the bank.
24. 10% of the Value of work done shall be deducted as retention money from the Interim payments made to the contractor, and shall be retained for Defects Liability Period (mentioned in the Appendix) and shall be released after the Defects Liability Period, provided no defects are noticed during the period. This retention money along with earnest money deposit and Initial Security Deposit would make the security deposit to be deposited by the contractor.
25. The Contractor shall attend to all defects noticed during liability period. If the Contractor fails to attend the defects, these defects shall be rectified by the Union Bank of India, Regional Office Samastipur, 1<sup>st</sup> Floor, Panchawati Complex, Mohanpur Road, Samastipur (Bihar) and the expenditure incurred on this account shall be recovered from security deposit.
26. The Contractor shall make adequate arrangement for watch and ward of his material and shall ensure the safety, breakage and any theft of materials fixed or unfixed by him or other sub contractors.
27. The Work executed should be got approved by the Union Bank of India, Regional Office Samastipur, 1<sup>st</sup> Floor, Panchawati Complex, Mohanpur Road, Samastipur (Bihar) and contractor shall rectify any bad workmanship pointed out at any stage and remove from site all the rejected materials immediately.
28. The Contractor shall be responsible for application of labour laws, compensation for injury and accident to person, whether employed by him or by his sub-contractor.
29. The Contractor shall take necessary precautions for carrying out the work avoiding any damage to structures/decorative parts of the property. The Contractor shall rectify damages done at his cost.
30. The Contractor shall ensure that workmen employed by him for execution of work are suitably covered against workmen's compensation Act and that all liabilities arising out of workmen's compensation Act, ESIS and other legislative enactment application to such works and workmen shall be to the contractor's account. The Contractor shall also ensure that he has gone under the closer of all sorts of insurance that are subjected to the said job, before commencing the job.
31. Furnishing, Civil, Water Supply, Furnishing and Demolition works shall be carried out as per drawing /specifications and to the entire satisfaction of the Union Bank of India, Regional Office Samastipur, 1<sup>st</sup> Floor, Panchawati Complex, Mohanpur Road, Samastipur (Bihar) and the Architect.
32. The Contractor shall give due notice to the Union Bank of India to check measurements of any which is likely to be hidden before covering the same.

33. The Contractor shall submit running bills for the value of work done mentioning full nomenclatures of items, rates, amount, measurements sheets, reasons, for part rates claimed, if any.
34. In case of non-completion or delay in completion of work or removal of defects in time the Union Bank of India, Regional Office Samastipur, 1<sup>st</sup> Floor, Panchawati Complex, Mohanpur Road, Samastipur (Bihar) shall be free to appoint another agency to get the job done at contractor's risk and cost.
35. For fixed as well as loose furniture, rates quoted by the contractors shall be inclusive; octroi transportation etc. and no extra amount shall be paid on this account. GST shall be paid by the Bank.
36. Income-tax (TDS) at the rate of 2% (or as applicable from time) of the bill amount shall be deducted at source from the contractor's bill and shall be deposited with the I.T.O as per rules.
37. The Union Bank of India, Regional Office Samastipur, 1<sup>st</sup> Floor, Panchawati Complex, Mohanpur Road, Samastipur (Bihar) may delay the progress of work without, in any vitiating the contract and grant such extension of time for the commencement / completion of the contract as it may think proper and sufficient in consequence of such delay and contractor shall not make claim for compensation or damage in relation thereof.
38. The contractor shall not execute any extra item without Union Bank of India, Regional Office Samastipur, 1<sup>st</sup> Floor, Panchawati Complex, Mohanpur Road, Samastipur (Bihar) permission in writing.
39. The quantities mentioned in the schedule of quantities are approximate. Payment shall be made on actual work done by the contractor. However, the contractor should not deviate the quantity without Union Bank of India, Regional Office Samastipur, 1<sup>st</sup> Floor, Panchawati Complex, Mohanpur Road, Samastipur (Bihar) permission.
40. Conditional tenders quoted by the Tenderer are liable to be rejected.
41. The Union Bank of India, Regional Office Samastipur, 1<sup>st</sup> Floor, Panchawati Complex, Mohanpur Road, Samastipur (Bihar) has a right to alter the nature of work and to add or omit any items of work or to have the option of the same carried out departmentally or otherwise and such alterations or variations shall be carried out without prejudice to this contract.
42. In case the particular make of material mentioned not available at the time of execution of the work, the alternative make of materials shall be got approved from the Union Bank of India, Regional Office Samastipur, 1<sup>st</sup> Floor, Panchawati Complex, Mohanpur Road, Samastipur (Bihar) / Architect before its use.
43. Arbitration - In case of any dispute between Union Bank of India, Regional Office Samastipur, 1<sup>st</sup> Floor, Panchawati Complex, Mohanpur Road, Samastipur (Bihar) & contractor, the decision taken by the arbitrator who shall be appointed by the

Union Bank of India, Regional Office Samastipur, 1<sup>st</sup> Floor, Panchawati Complex, Mohanpur Road, Samastipur (Bihar) shall be final.

(Union Bank of India, Regional Office Samastipur)

(Contractor)

**Appendix Referred in the General Conditions**

- Defects liability period: - 12 months.
- Date of commencement: - 2<sup>nd</sup> day from the date of issue of letter awarding the job
- Stipulated period for completion: - 21 days from the date of work order.
- Initial Security Deposit till completion of work (ISD): - 2% of the accepted contract value.
- Retention Money: - 10% to be deducted from interim payment.
- Security deposit for defects liability period: - The Security deposit shall be worked out as under-  
$$(SD) = EMD + ISD + RM$$
- Liquidated damages for non-completion of work within stipulated period. The Tenderer shall have to pay liquidated damages for non completion of job within stipulated period at the rate of Rs.1,000/- per day for the first week and Rs.2,000/- per day after that, with a maximum limit of 5% of the total contract value.

## **Technical Specification for Furnishing Works**

1. While quoting rate for item of work, the contractor shall also include for the following irrespective of whether it has been mentioned or not in the detailed specifications of the item. The contractor shall not be paid any extra cost.

All ply board /plywood/door shutters used shall be phenol bonded, exterior (BWP) grade Confirming to latest relevant IS codes shall be used.

All unexposed surface of wood /ply board/plywood (any variety) used shall be treated with necessary coats of anti termite treatment.

All unexposed surface of wood /ply board/plywood (any variety) used shall be treated with synthetic enamel of approved make unless otherwise specified.

All metal work shall be treated with anti corrosive treatment.

All exposed edges of wood (any variety) shall be finished with wood primer / putty and paint/melamine finish /distress stain police etc.

All exposed edges of wood /ply board / plywood (any variety) used shall be finished with 6.0 mm thick teakwood lapping unless otherwise specified.

All brass work, fitting & fixtures shall have lacquered finish.

2. The specifications which are not included in the technical specifications mentioned in the tender shall be as per ISI specifications/ Instruction of Employer / Architect.

3. Thickness used shall be as following unless otherwise specified

Laminated used shall be 1.0mm thick.

Teak or cedar veneer /ply used shall be 4.00 mm thick.

Waterproof ply shall be 9/6 mm thick as required

Waterproof board shall be 19 mm thick.

4. The Contractors are advised to refer the drawings for dimensions, sizes, etc, to cross check the BOQ and than quote accordingly.

Any sub standard materials used during the execution shall be rejected. The contractor shall replace the same, to the entire satisfaction of the Union Bank of India, Regional Office Samastipur. The Tenderer shall have to pay liquidated damages for non completion of job within stipulated period at the rate of Rs.1,000/- per day for the first week and Rs.2,000/- per day after that, with a maximum limit of 5% of the total contract value and Architect, at his own cost.

5. The Contractor of his authorized representative shall remain at site supervise the total project. The representative shall always bear a copy of authority letter from the contractor and a copy of it shall be submitted to Branch Manager.
6. The Contractor shall also submit on undertaking to the branch manager mentioning that he shall bear the total responsibility for any sort of injury of physical damage done to the sub structure and ground floor, nearby structures, workmen employed at site staff member of bank, public coming to bank, residents staying nearby, passerby etc. Bank does not hold any responsibility for any sort of disputed or accident, which has arisen from the said job. All of them shall be on the contractor's account.
7. The Contractor shall not be paid extra for making of any cut out / opening for FURNISHING / air - conditioning wiring / fitting in any of the item of false ceiling, partitions, paneling, skirting, masonry work etc.
8. The Contractors shall fabricate and submit, at site, one or more samples of each item as instructed by Union Bank of India, Regional Office Samastipur. The Tenderer shall have to pay liquidated damages for non completion of job within stipulated period at the rate of Rs.1,000/- per day for the first week and Rs.2,000/- per day after that, with a maximum limit of 5% of the total contract value. / Architect for approval. The bulk production of the each item shall be taken in hand only after the final approval of sample of each item. It shall be the entire responsibility of the contractor to get the sample approved by The Union Bank of India, Regional Office Samastipur / Architect spending the minimum time and no extension of time shall be granted for getting the late approval of samples. The approved sample shall be kept at site in the custody of the Union Bank of India, Regional Office Samastipur (Bihar) and Architect. However, the same shall be taken back by the contractor after the completion of work in all respects.
9. The Contractor , whenever asked shall submit basic unit rates of all constituent materials and labour required for completion of any particular item. These rates shall be for the analysis of any extra or substituted items.
10. Openings in partitions / paneling/ ceiling etc. shall be deducted as per IS specifications

List of Furnishing Material for Kishunpur Baikunth (Warisnagar) Branch, Union Bank of India

Description of Material	Make of Material
Plywood	Anchor / Archid / Century / Kenwood / Garnet / Samrat / Green / Mayur or equivalent (6mm, 9mm, 12mm, 19mm).
Laminates	Formica / Greenlam / Century / Signature / Heritage / Archid / Newmica / Kitmica or equivalent. (1.0 / 1.5mm thick)
Block board	Anchor / Century / Archid / Green / Marino / Multiply or equivalent.
Soft Board (pin up board)	Jolly board, Western India plywood or equivalent.
Gyp. board	India gypsum or equivalent.
Metal ceiling	Luxelon, Superseal, Trident, Armstrong or equivalent.
Vertical blinds	Vista, Universal or equivalent.
Screws	GKW / Mettle fold or equivalent
Brass hinges	Reliance / Punit heavy duty or equivalent.
Hardware	Shalimar, Everite / Reliance or equivalent (brass powder coated)
Drawer shutter lock	Vijayan / Godrej (3 set of keys) or equivalent.
Ball catch	Magnetic (M-2) / Brass or equivalent.
Door lock / handles	4-C ACME, Golden, Godrej, Ultra or equivalent.
Veneer	Anchor / URO / Durian / Century or equivalent.
Adhesives	Fevicol (SH), Mowicoll, Mahacol, Araldite or equivalent.
Wood preservatives	Woodguard, PCI, Black Japan or equivalent.
Door closure	Yale / Efficient gazets, Everite Hyper ,Godrej or equivalent.
Glass	Modi / Triveni / Hindustan Palington / Asahi / Saint Gobain or equivalent.
Glass tinted	Same as above.
Melamine Polish	Asian paint, MRF, Nerolac or equivalent
	French / Zinc oxide or equivalent
Paint	ICI, Burger, Nerolac, Asian.
AC grill	Air products, Omicron, Patrawala
Vitrified tiles	Marbonite of HR Jhonson, Navin ,Somany
Ceramic tiles	Jhonson & Jhonson, Kajaria, Nitco, Regency or equivalent
Alu. Door & window sections	Ajit India / Jindal / Indal / Bhansali or equivalent of 25 microns.

Floor springs	Everite / Hemco / Hyper or equivalent
Wood preservative	Asian paint / British paint or equivalent
Cement	L&T / Narmada / ACC / Ambuja / Birla or equivalent of 43 / 53 grade as required.
White cement	Birla cement, JK cement or equivalent.
Sun control film	Garware or equivalent
Stainless steel sink	Nirali / Diamond or equivalent.
Carpet	Hitkari / Modi / Trans Asia or equivalent.
Rubber foam	34 density mm foam
WC seat cover	Commander / Patel / Supreme or equivalent.
Toilet paper holder	Parryware / Hindustan / Nycer or equivalent.

Note: All materials shall confirm to IS / BIS respective numbers.





- Commercial ply shall conform to IS 303.
- Marine ply shall conform to IS 710.
- Block Board shall conform to IS 1659.

OPTION:-04

## NOTES

- All dimensions to be read not to be scaled.
- This drawing supercedes all other previous drawings.
- Dimensions are in inches except otherwise.
- This drawing should be read in conjunction with relevant structural drawing and any discrepancy noticed should be got clarified before execution.
- The drawing is the property of the architects.
- Any copying or reproduction of this drawing should only be done after a written permission of the architects.
- Any defaulter is liable to be sued for the violation of the copyright act.

## LEGEND:-

	HALF HT PARTITION
	7' HT PARTITION
	SEMI GLAZED FULL HT PARTITION
	SOLID FULL HT PARTITION

TOTAL INTERNAL  
AREA = 1448.00sqft.(Approximate)

## PROJECT

PROPOSED INTERIOR LAYOUT OF  
**UNION BANK OF INDIA**  
AT-WARISNAGAR BRANCH

## CLIENT

**UNION BANK OF INDIA R.O.  
SAMASTIPUR**

## DRAWN BY

Digesh kumar

## CHECKED BY

Ar. Amit Kumar

## NORTH



## SCALE

NOT TO SCALE

## DATE

27-02-2021

## REVISION

22-02-2022

## SHEET TITLE

(ID-1)

## DRAWING TITLE

**INTERIOR LAYOUT**

## ARCHITECT :-



**ARTCON DESIGN  
CONSULTANTS**  
ARCHITECTS ENGINEERS  
INTERIOR DESIGNERS COMPUTER AIDED DESIGN  
G-04 Laxmi Palace, Mitra Compound, Boring  
Road - Patna - 800001  
+91 9931723771, amikumar73@gmail.com  
+91 9386717726 artcondesignconsultants.com

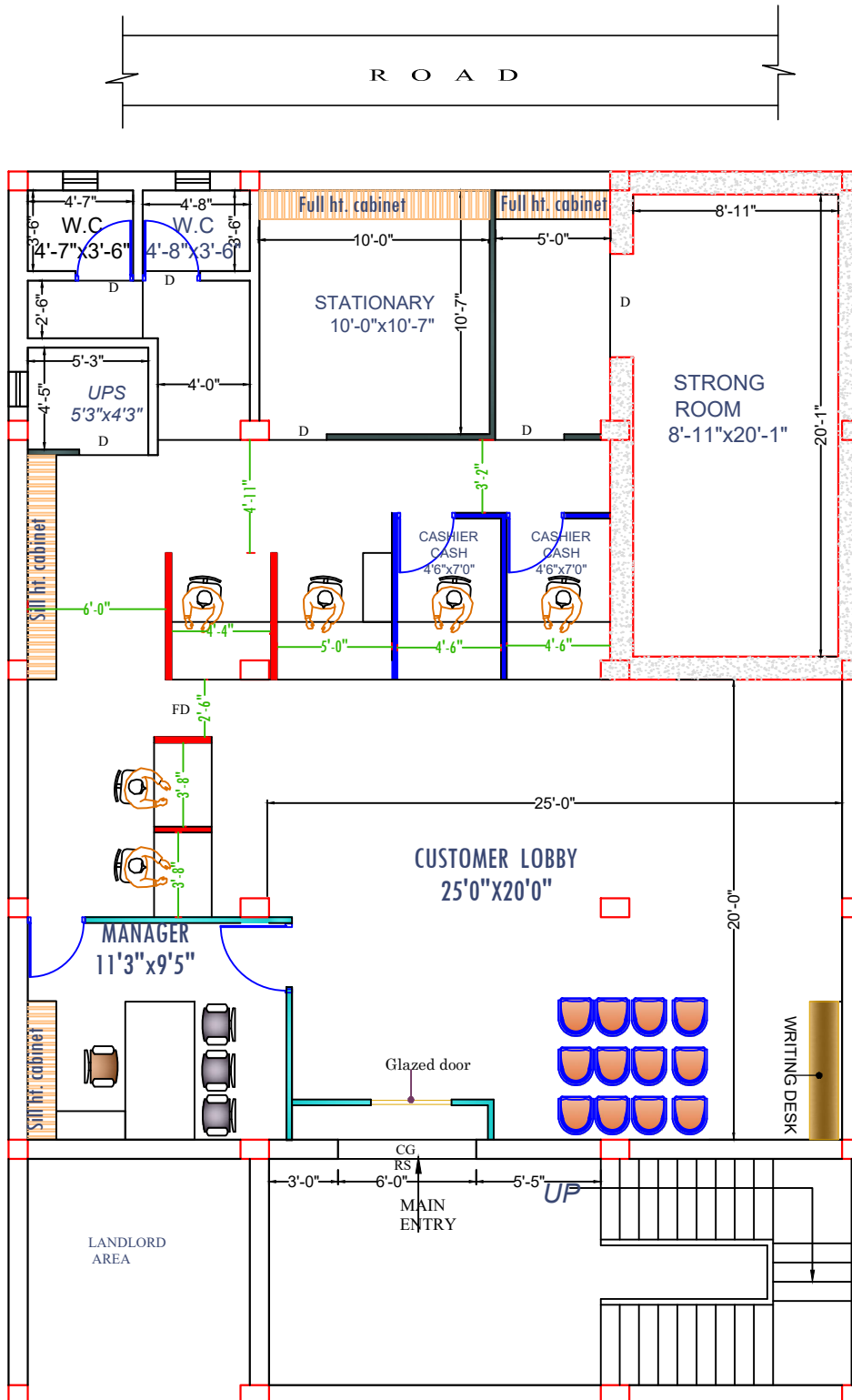

**FIRST FLOOR PLAN**

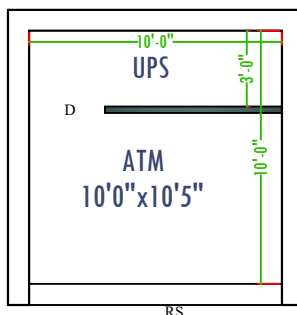

**ATM GROUND FLOOR PLAN**



**ARCHITECT- ARTCON DESIGN CONSULTANTS, PATNA**

**CLINTE- UNION BANK OF INDIA**

**PROJECT- UNION BANK OF INDIA, WARISNAGAR BRANCH**

THE FOLLOWING MAKE OF MATERIALS AND EQUIPMENTS SHEEL BE USED IN THE WORK. IN THE EVENT OF NON AVAILABILITY OF CERTAIN ITEMS, THE APPROVAL OF THE ARCHITECT/ELECTRICAL ENGINEER/EMPLOYER MUST BE OBTAINED IN THE WRITING PRIOR TO USING SUBSTITUTE MAKE.

LIST OF APPROVED MAKES OF ELECTRICAL ACCESSORIES & SWITCHGEARS:

SL NO	ITEM	MAKE
1	PVC CONDUIT & ACCESSORIES	AKG/ CAPS/MALHOTRA – ISI MARKED
2	COPPER WIRE PVC INSULATED FR	HAVELL'S /FINOLEX/RR KABLE
3	MODULAR SWITCH & BOARDS	ROMA/CRABTREE/L&T/ LEGRAND
4	MCB& MCB DB	LEGRAND/SIEMENS/SCHNEIDER
5	LED LIGHT FITTINGS	PHILIPS/MAGIK LED (CENTURY)/ HAVELL'S
6	CEILING/WALL/EXHAUST FAN	KHAITAN/HAVELL'S/CROMPTON
7	MCCB	L&T/SCHNEIDER/ABB.
8	CHANGEOVER	HPL /L&T/ ABB
9	MULTIFUNCTIONAL METERS	SCHNEIDER/HPL/L&T
10	CURRENT TRANSFORMER	AE/KAPPA/ESSMA
11	HRC FUSE	L&T/HAVELL'S /GE
12	TELEPHONE WIRE	HAVELL'S /FINOLEX/RR CALEL
13	CALL BELL	CONA/ANCHOR
14	LT PANEL/ UPS PANEL	CPRI TESTED MANUFACTURER
15	AC CONTROLLER	NORTH WEST/ LEGRAND
16	LUGS	DOWELL'S/JAINSON
17	NET-WORKING HUB	D-Link/ LEGRAND
18	VRF AIR CONDITIONING	LG/DAIKIN/CARRIER

**BILL OF QUANTITY OF INTERIOR DESIGN AND FURNITURE WORKS FOR UNION BANK OF INDIA,  
WARISNAGAR BRANCH AND ATM**

SI. No.	DESCRIPTION	UNIT	QTY.	RATE	AMOUNT
	Note-I: Anti-termite with Chloropyrphos of approved band and make to be done on all wooden surfaces.				
	Note-II: Wherever painting items are mentioned, these always include the base coats of primer required and a minimum of 2 coats of the Final paint. Anti-termite with Chloropyrphos of approved brand and make to be done on all wooden surfaces.				
1	<b>(FULL HEIGHT PARTITION)</b> Providing and fixing fullheight double skin partitions in cabins etc, with frames of 2" x 2" (finished size) seasoned hardwood members (hollock / malaysian sal) at max. intervals of 2'-0" x 2'-0" c/c with provision of bigger members at skirting, fixing to door frames, etc, all wood work to be treated with 1st quality anti-termite paint, and covered with 6 mm thick Plywood of approved make covered with various finishing layers as per design and details including 1 mm thick laminate. (All visible wood to be of 1st quality "ghambhar") and shall be painted with Premium 1st quality paint / polished as per instructions of Bank. Laminates shall have a number of horizontal / vertical grooves and the ply under such grooves shall be painted with approved colours. Opening for communication / conversation shall be provided as required as per detailed design and nothing extra shall be paid / deduction for the same. The height of the partition shall be measured upto the R.C.C. Roof, if applicable. All doors including sliding doors / openable doors, with all fittings including ISI Marked Bolts, etc., shall be included in the same price. Doors shall be of heavy sections matching the partition, and shall have 8.0 mm thick etched glass as per design. All items necessary for completing the above mentioned work are deemed to be included in the scope of work, whether or not they are specifically mentioned in the B.O.Q / tender documents / drawings.	S.Ft.	340.00		
2	<b>Semi Glazed Partition</b> -The partition between the level 3'-0" to 7'-0" have 6 mm thk Float glass with 3M Make CRYSTAL engraved etching film. Glass panel as an insert with 3 1/4"x1" thk. beach wood (BW) beading with melamine spray polish including all hardwares etc. complete. The partition should be firmly fixed on floor/ counter/ wall. Opening for communication / conversation shall be provided as required as per detailed design and nothing extra shall be paid / deduction for the same. All doors including sliding doors / openable doors, with all fittings including ISI Marked Floor Springs, Hinges, Bolts, etc., shall be included in the same price. Doors shall be of heavy sections matching the partition as per design. and shall have 8.0 mm thick etched glass as per design. All items necessary for completing the above mentioned work are deemed to be included in the scope of work, whether or not they are specifically mentioned in the B.O.Q / tender documents / drawings.	S.Ft.	220.00		

3	(HALF HEIGHT PARTITIONS-FULLY PANELLED) (4'6" ht) The partition between the level 3'-0" to 4'6" have 12 mm thk Float glass .Providing and fixing half height double skin partitions in cabins etc, with frames of 2" x 2" (finished size) seasoned hardwood members (hollock / malaysian sal) at max. intervals of 1'-6" x 1'-6" c/c with provision of bigger members at skirting, fixing to door frames, etc, all wood work to be treated with 1st quality anti-termite paint, and 6 mm thick Plywood of approved make covered with various finishing layers as per design and details including 1 mm thick laminate. (All visible wood to be of 1st quality "gamhar") and shall be painted with Premium 1st quality paint / polished as per instructions of Bank,Ghambhar Frame shall be neatly painted / polished to a glossy finish with premium quality paint / polish. All necessary hardware such as hinges, bolts, etc, and any other hardware required for the wicket door, shall be included in the price.Laminates shall have a number of horizontal / vertical grooves and the ply under such grooves shall be painted with approved colours.Openings for communication / conversation shall be provided as required as per detailed design and nothing extra shall be paid / deduction for the same.All electrical wires, accessories, telephone wires, etc, shall be run in the partition without any extra charges for the same.All items necessary for completing the above mentioned work are deemed to be included in the scope of work, whether or not they are specifically mentioned in the B.O.Q / tender documents / drawings.All exposed wooden surfaces are to be painted with Premium quality paint as per Specifications.	S.Ft.	105.00		
4	(COMPUTER CASH AND CASH CAGE PARTITIONS - FRONT) Providing and fixing cash cage glazed partition on top of cash counter facing the customer with 12 mm thick clear float glass (Modiguard) fixed in a frame of 2" x3" teakwood on all three sides, duly polished, all beading etc. as required, all cutting of glass as required, all complete.	S.Ft.	42.00		
5	(COMPUTER CASH AND CASH CAGE PARTITIONS - SIDES & REAR) Providing and fixing cash cage partition, as per specifications given in Item No. 1a above, modified in height and the openings required to suit the requirements of cash cages, with the exception that in addition to 5.0 mm glass, aluminium mesh shall be given in all cash cage partitions, etc, from 4'-0" to 7'-0", along with supporting members all doors, as per specifications given in Item No. 1 above, all hardware for doors excluding door closers, godrej night latches which shall be paid for separately, all complete. The front of the cash cage shall be done in a decorative design, as shown in the attached drawings and details.	S.Ft.	217.00		
6	(ALUMINIUM MESH ON TOP OF CASH CAGE) Providing and fixing aluminium mesh cage on top of cash cage area, all complete with polished gambhar wood frame, duly supported at regular intervals to prevent sagging, all complete.	S.Ft.	70.00		
7	(HYDRAULIC DOOR CLOSER) Providing and fixing Hydraulic door closers of specified brand, all complete as per instructions of Architect / Employer.	Each	6.00		
8	(LOCKS) Providing and fixing "Godrej Night Latch" / "Godrej Mortice Lock" in required places, all complete with fixing, fitting, etc.	Each	6.00		
9	(EXECUTIVE TABLES) Providing and Placing new executives tables alongwith matching credenza of plan size (basic) as given below and credenza of plan size as given below, table top to be made of 19 mm thick plywood of approved make, edged with beading of 2" x 1-12 approx), cut to required shape, top of table to have 1.0 mm thick laminte, and teakwood beading to be polished to required colour and finish. Table to have a vertical modesty panel of 19 mm thick plywood of approved make laminated/Plain with laminate (1.0 mm thick) from the outer side and painted with minimum 2 coats of premium 1st quality paint on the inner side. Modesty partition to have 1st quality beading on top as per design and specifications and Quality Enamel paint over appropriate priming coat on the internal surface.				

	Laminate to have a no. of grooves as per design and drawings. A chest of drawers shall support the table on 1 side (except in the case of staff tables of 4'-0" width, where the table shall be supported on one side by the credenza unit) integrally connected to the modesty partition, made of 19 mm thick commercial plywood of approved make, drawers to slide on drawer slides (EBCO / Equivalent), and made of 19 mm thick grade bwp board for all sides and bottom cabinet shutters of 19 mm thick commercial plywood of approved make, cabinet hinges to be t-type, self closing, EBCO / Equivalent, all edges of all blockboard / plywood to be sealed with 1st quality teakwood edging, including blockboard members touching the ground.				
	Drawers and cabinet shutters to be laminated on all external surfaces with 1.0 mm thick laminate, and painted on all visible internal surfaces with premium 1st quality enamel paint as Specified above. All drawers and cabinets (both in tables and credenza) to be provided with high quality 'Gogrej' locks, and high quality handles as per Item No. B above. Drawers and cabinets, cabinet shutters, etc. <b>to be Shutter will be hung by auto-closing hinges, locks, magnetic door catcher and satin finished S. S. handles etc.</b> of approved make as described in table specifications above, including all finishing details, and one glazed cabinet shutter in 1st Quality Teakwood frame, finished with laminate also to be laminated with 1.0 mm thick laminate grooves as / design. Keyboard unit as per design and specification to be included in the rate.				
a)	Senior Manager (6'-0" x 3'-0")	Each	1.00		
b)	Credenza (1'3"x3'0")	Each	2.00		
c)	Full Ht cabinet;-(elevation area calculation))	SFT	120.00		
d)	Sill Ht cabinet;-(elevation area calculation))	SFT	40.00		
e)	Centre table (3'0"x2'0")	Each	1.00		
10	(COUNTERS) Providing and fixing COMPUTER COUNTERS (formerly from as LEDGER COUNTERS) made out of 19 mm thick plywood of approved make and as per the attached drawing, all complete with 1.0 mm thick laminate on all visible surface, tabletops, customer top, etc, and all drawers etc. to be painted with 1 coat of primer and 2 coats of 1st quality enamel paint). 12 mm thick glass, MODIGUARD/ASAHI, branded, to be used on top of the COMPUTER COUNTER. Keyboard Tray to be provided on Special Keyboard Slides, and wristrest to be given. Drawer Slides to be used for all drawers. All locks to be of Godrej / Linc. All drawers, cabinets, Keyboard, etc. to be lockable. Footrest to be provided. (See Detailed drawing attached). The Front of the Computer Counter shall have decorative finishing in ply and laminate as shown in the drawing attached.	R.Ft.	17.50		
11	Cash counter :- Size 5'0"x6'0"x3'8" (LxWxH) , table top should be in two levels, the top level shall be 1.5' as customer top at 3'10" level. The front shall be 12 mm thick toughened glass up to 7' level. All exposed glass face to be machine polished. The counter shall be made of 18mm bwp ply board, with 1.0mm laminate as per drawing detail enclosed, storage unit with drawers, and keyboard and pencil drawer on channels, cable manager, and laminated apron to match décor. Drawer unit and verticals made out of 18mm ply board with keyboard drawers and 3 cash drawers (18"Wx24"Dx8"H) with note separator made out of 12mm ply board for footrest finished with enamel paint .All drawers to be provided with Godrej lock & SS handle of approved make. The exposed side of front faced, drawer front shall be finished with 1mm laminate as per drawing enclosed. The inside shall be French polished.	R.Ft.	9.50		
12	(NOTICE BOARD) Providing and fixing a notice board near the Waiting area, frame to be made of 1st quality hardwood, and infill of 12 mm thick 'Celotex' board, duly covered with "Matte" quality cloth of approved colour and make. Visible surfaces of Frame to be painted with "Premium 1st Quality Paint" in approved colour and shade, and internal frames and internal surface of celotex board to be painted with priming coat. The frame is to be securely fixed to the wall, all complete as per directions for the Architect / Employer. Size: 3'-6" x 2'-0".	Each	1.00		

13	Main Entrance Door: Full.ht.Glass Partitions (WITH DOOR )Entrance side Providing and fixing 12 mm thk. full ht. Toughened Glass partitions with etched horizontal liner of 1"ht. and 1/2"clear space in between as per design ,Rate should be inclusive of additional Alluminium profile fixed in the flooring and above finished false ceiling level with necessary patch fittings as required to hold the glass partition. All exposed edges surfaces should be machine polished edges. The Rate shall be also inclusive of floor spring ,necessary hardware 3'-0"ht. Matt steel door handles with floor locking arrangement of Enox co. etc. Complete as per desgins and details from the Architects.The rate shall be Inclusive of Horizontal Etched Lining in between 3' to 6' ht. horizontal etched lining of 1"frost and 1/2" clear as per design etc. complete. Supplying and fixing banks logo – sticker as per drawing and design. Glass wall as per design and instruction by Architect /Enginee	S.Ft.	110.00		
14	<b>(SUGGESTION BOX)</b> Providing and fixing one suggestion box, made with 12 mm ply as per standard design and specifications of the Bank, fully complete, with enamel painting, lock, lettering on top, etc.	Each	1.00		
15	Providing and fixing Cheque writing/slip rack projected/supported from wall6'0" x1'-3" and a C.T. as per design with suggestion box,first aid box,sugestion box.	Each	1.00		
16	<b>(CHECK DROP BOX)</b> Providing and fixing one suggestion box, made with 12 mm ply as per standard design and specifications of the Bank, fully complete, with enamel painting, lock, lettering on top, etc.	Each	1.00		
17	Planter -size 1'6"x1'6"x1'3" with 19mm board,1mm laminated & 12mm rubber wood all as per design	NOS	0.00		
18	<b>FALSE CEILING</b>				
i)	<b>Gypsum board false ceiling with Vertical band /drop of 6"</b> <b>Gypsum board false ceiling with Vertical band /drop of per detail drawing &amp; instructions of Architect</b>				
	Providing and fixing in position Gypsum Board False Ceiling including Two coats of Plastic emulsion Paint of appd.quality as per manufacturer's specifications and instructions with 12.5 mm thick 'Gypboard' Screw-fixed to the underside Of suspended G.I. grid. G.I. grid should be Constructed and suspended from the main ceiling as per manufacturer's instructions and as per specifications using Original Co. Specified Framework Sections G.I.24 gauge The Gypboard should be fixed to G.I. grid with 25 mm long Drawali Screws. The 'Gypboard ' to be used should be 12.5mm thick tapered edge boards. The boards should Be taped and filled from underside to give smooth, seamless ceiling. The rate should include necessary additional ceiling sections and intermediate channels openings for light fixtures, A.C. ducts, vertical drops, offsets. etc.				
	Additional Intermediate channels should be fixed to strap hangers for additional support to prevent strap hangers from buckling/swaying at every 1200 mm. Item to be completed in all respect including necessary sleeves for ducts finishing of joints cut outs supports for A.C. grills, light fixtures, speakers etc.Make: Gypusm board-India Gypsum. Panint-Asian/ ICI The rate should include necessary additional ceiling sections and intermediate channels openings for light fixtures, A.C. ducts, vertical drops, offsets.and with two coats of putty, two coats of approved primer, and three coats of approved lustre pain	SQ.FT.	450.00		
ii)	<b>Grid False Ceiling</b>				

	Providing & fixing false ceiling at all heights with GRG (Glass Fibre Reinforced Gypsum) false ceiling tiles of Size 595x595 mm of approved texture, design and patterns having moisture content less than 2%, humidity resistance of 99%, NRC 0.50 to 0.75 as per IS 8225:1987, Non combustible as per BS 476 (part-4)-1970 and light reflectance of 85% (minimum) to be laid in true horizontal level suspended on inter-locking metal T-Grid of hot dipped galvanised iron section of 0.33mm thick (galvanized @ 120 grams per sqm including both sides) comprising of main-T runners of size 15x32 mm of length 3000 mm, cross - T of size 15x32 mm of length 1200 mm and secondary intermediate cross-T of size 15x32 mm of length 600mm to form grid module of size 600 x 600 mm, suspended from ceiling using galvanised mild steel items (galvanizing @ 80 grams per sqm) i.e. 50 mm long, 8 mm outer diameter M-6 dash fasteners, 6 mm dia fully threaded hanger rod upto 1000 mm length and L-shape level adjuster of size 85x25x2 mm. Galvanised iron perimeter wall angle of size 24x24x0.40 mm of length 3000 mm to be fixed on periphery wall / partition with the help of plastic rawl plugs at 450 mm center to center and 40 mm long dry wall SS screws. The work shall be carried out as per specifications, drawing and as per directions of Engineer-in-Charge	SQ.FT.	670.00		
19	Column Panelling : Column & Wall panelling within 1 ½"x1" hardwood fixed to the column and then finished with 6mm ply & above should be laminated with 1.5mm laminate of approved make and as per drawings and instruction of the architect. A wooden cornice of size 3"x2" has to be fixed on the edge and around the pillar as per design duly polished as per instructions of the Architect. (upto 8'0" height)	SQ.FT.	165.00		
20	Painting:- scratch the old paint surface and apply two layer of wall putty with primer and paint with plastic emulsion paint three coat over the wall putty of approved brand and manufacturer( Asian and Nerolac) of required colour to give smooth/silky look surface on wall,as per approved design and direction of the bank/Architect	SQ.FT.	4200.00		
	<b>TOTAL</b>				
	<b>G.S.T(Extra as applicable)</b>				
	<b>Notes:-</b>				
	Contractor to Note that:-				
a)	Footrests to be provided (laminated) with each table / counter without any extra charges, @ 1 per person.				
b)	Extra members, wherever required for stability / otherwise, to be provided with the required finish without ant extra charges.				

ESTIMATE OF INTERIOR DESIGN AND FURNITURE WORKS FOR UNION BANK OF INDIA, WARISNAGAR BRANCH, ATM					
Sl. No.	DESCRIPTION	UNIT	QTY.	RATE	AMOUNT
1	Paneling in the CD room providing &fixing in position .ACP (Aluminium Composite panel) with framing of aluminium tube section of min1.5"x1"and 20 gauge 2'-0" c/c both way .ACP to be in 2' wide or distributed equally .panel to be fixed to the frame with 3m or equi-valent adhesive .joints to be finished with silicon based sealant .ACP thicknessof 3mm.	S.FT.	190.00		
2	Providing &fixing ,ATM Grouting	No.	0.00		
3	Providing &fixing Back room partition ACP. (Aluminium Composite panel) with framing of aluminium tube section of min1.5"x1"and 20 gauge 2'-0" c/c both way .ACP to be in 2' wide or distributed equally .panel to be fixed to the frame with 3m or equi-valent adhesive .joints to be finished with silicon based sealant .ACP thicknessof 3mm. (Back side covered with 6mm BWR ply )	S.ft.	100.00		

4	Main Entrance Door: Full.ht.Glass Partitions (WITH DOOR)Entrance side Providing and fixing 12 mm thk. full ht. Toughened Glass partitions with etched horizontal liner of 1"ht. and 1/2"clear space in between as per design ,Rate should be inclusive of additional Alluminium profile fixed in the flooring and above finished false ceiling level with necessary patch fittings as required to hold the glass partition. All exposed edges surfaces should be machine polished edges. The Rate shall be also inclusive of floor spring ,necessary hardware 3'-0"ht. Matt steel door handles with floor locking arrangement of Enox co. etc. Complete as per designs and details from the Architects.The rate shall be Inclusive of Horizontal Etched Lining in between 3' to 6' ht. horizontal etched lining of 1"frost and 1/2" clear as per design etc. complete. Supplying and fixing banks logo – sticker as per drawing and design. Glass wall as per design and instruction by Architect /Enginee	S.FT	100.00		
5	(FALSE CEILING)Providing & fixing false ceiling at all heights with GRG (Glass Fibre Reinforced Gypsum) false ceiling tiles of Size 595x595 mm of approved texture, design and patterns having moisture content less than 2%, humidity resistance of 99%, NRC 0.50 to 0.75 as per IS 8225:1987, Non combustible as per BS 476 (part-4)-1970 and light reflectance of 85% (minimum) to be laid in true horizontal level suspended on inter-locking metal T-Grid of hot dipped galvanised iron section of 0.33mm thick (galvanized @ 120 grams per sqm including both sides) comprising of main-T runners of size 15x32 mm of length 3000 mm, cross - T of size 15x32 mm of length 1200 mm and secondary intermediate cross-T of size 15x32 mm of length 600mm to form grid module of size 600 x 600 mm, suspended from ceiling using galvanised mild steel items (galvanizing @ 80 grams per sqm) i.e. 50 mm long, 8 mm outer diameter M-6 dash fasteners, 6 mm dia fully threaded hanger rod upto 1000 mm length and L-shape level adjuster of size 85x25x2 mm. Galvanised iron perimeter wall angle of size 24x24x0.40 mm of length 3000 mm to be fixed on periphery wall / partition with the help of plastic rawl plugs at 450 mm center to center and 40 mm long dry wall SS screws. The work shall be carried out as per specifications, drawing and as per directions of Engineer-in-Charge	S.FT	63.00		
6	<b>Sutter covering</b> with ACP (aluminium composite panel) of approver color & make with the provision of rolling shutter maintenance trap door , allcomplete job as per standard & specification.	SQ.FT.	75.00		
7	Aircon Louvers (P and F 6" powder coated aluminium Louvers.)	SQ.FT.	2.00		
8	Providing and applying of 2 coats of enamel paint to existing shutter both side .	SQ.FT.	0.00		
9	Perforated Bin, steel Dustbeen-Size 18" high and 12" in diameter, MS perforated powder coated Rubber gasket on the floor end of the Bin, Bin grouted on the floor	EACH	1.00		
10	Providing footmat/doormat of size 36" X 24"	EACH	1.00		
11	Painting ATM back room :- Providing and apply two layer of wall putty with primer and paint with plastic emulsion paint three coat over the wall putty of approved brand and manufacturer( Asian and Nerolac) of required colour to give smooth/silky look surface on wall,as per approved design and direction of the bank/Architect	SQ.FT.	160.00		
<b>TOTAL ATM WORK</b>					
<b>SUB TOTAL (BRANCH+ATM)</b>					
<b>G.S.T(Extra as applicable)</b>					

<b>List of Approved Makes of Materials</b>					
Sl No.	Description of material				
1	Plywood/Block board (BWR)	6mm, 9mm, 12mm, 19mm	Kitply / Green panel / Austin/Mayur		
2	Laminate	1.0 mm	Greenlam/Merino/ NewmiKa		

3	Glass	6mm, 8mm,10mm, 12mm,	Modi /Saint gobain
4	Vertical blinds		Vista, Universal
5	False ceiling		USG Boral/Saint gobain/Hicem
6	Flush door shutter		Green ply /Century ply/ kitply
7	Veneer	4 mm	Century/ Green/
8	Wooden flooring	10mm,15mm	(Mikassa ) Green lam
9	Lock/Door Closures/Hardware		Godrej/Dorset/Hardwyn
10	Screws		GKW / Mettle fold /Netfold
11	Paints		ICI/ Burger/ Nerolac/ Asian
12	AC grill		Air products/Omicron/Patrawala
13	Channels ,Slides, Fitting		Ebco/Hettich/ Godrej/dorset
14	Aluminum Section (If Required)	Powder coated finish	Jindal/Indal
15	Floor springs		Hyper/ Dorma/Hardwyn/dorset
16	Melamine Polish		Asian paint, Nerolac
17	Wood preservatives		Woodguard, PCI, Black Japan
18	Calcium Silicate Board	12mm	Hilux